

**Notes**

1. IF IN DOUBT - ASK !!!
2. THIS DRAWING IS TO BE READ IN CONJUNCTION WITH ALL ARCHITECTS AND ENGINEERS DRAWINGS.
3. ALL WORK TO BE CARRIED OUT IN ACCORDANCE WITH THE RELEVANT BRITISH STANDARDS, CODES OF PRACTICE AND BUILDING PRACTICE.
4. ALL DIMENSIONS TO BE CHECKED PRIOR TO STARTING THE WORKS ON SITE. ANY DISCREPANCIES TO BE REPORTED TO THE ENGINEER IMMEDIATELY.
5. CONTRACTOR TO ASCERTAIN THE LOCATION OF SERVICES ON SITE PRIOR TO STARTING THE WORK.
6. ALL DIMENSIONS FOR CONSTRUCTION ARE TO BE OBTAINED FROM SITE MEASUREMENTS OR ARCHITECTS SETTING OUT DRAWINGS PRIOR TO MANUFACTURE/BUILDING.

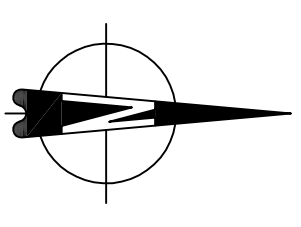
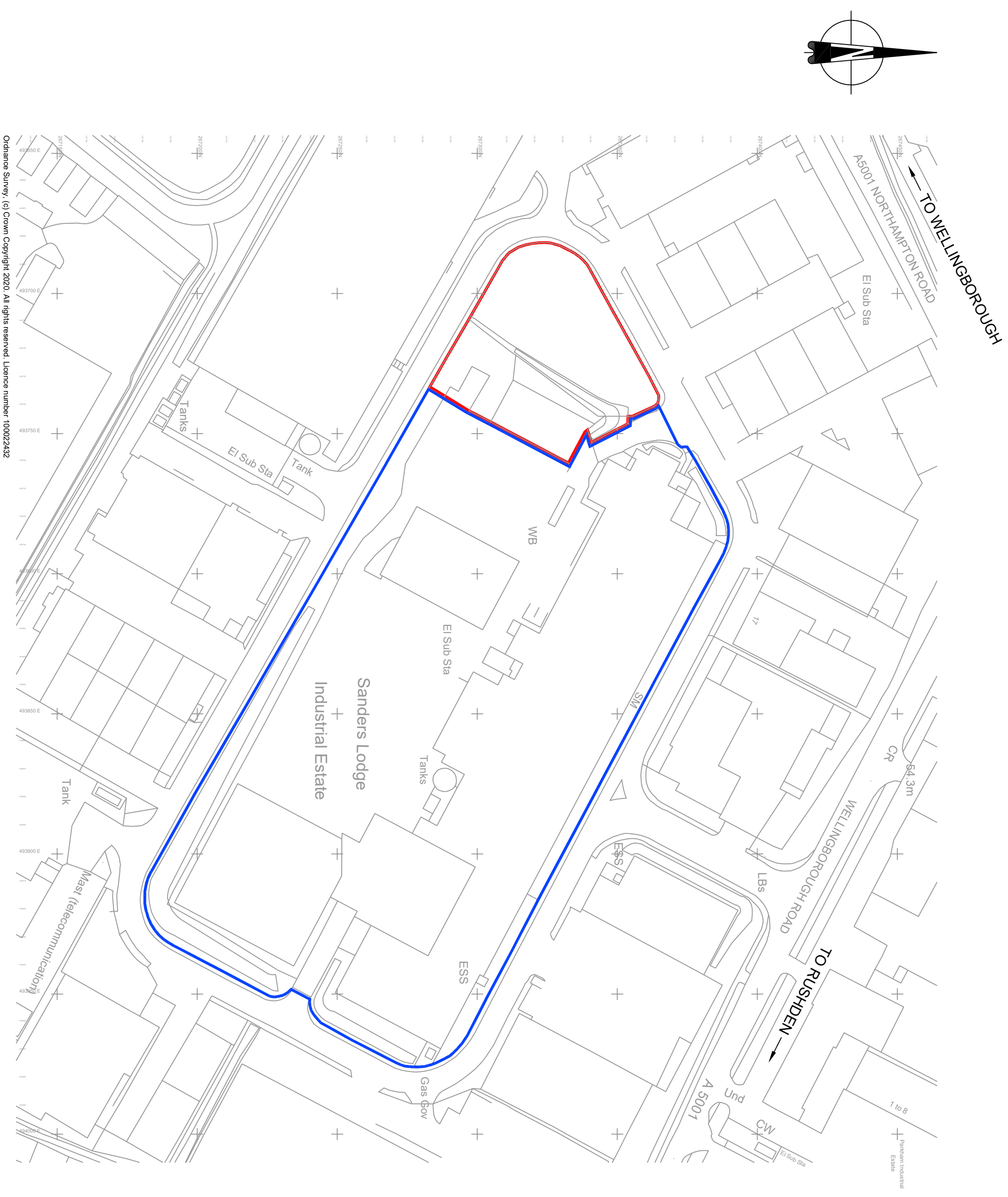
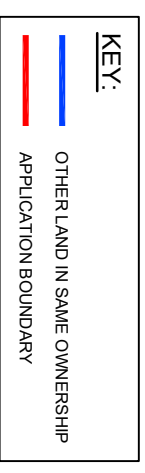

Ordnance Survey, (c) Crown Copyright 2020. All rights reserved. Licence number 100022432

ISSUE	REVISION	DATE	BY	DATE
P1	FIRST ISSUE	05.08.20	GM	

THIS DRAWING IS THE PROPERTY OF DAVID SMITH ASSOCIATES. IT MUST NOT BE REPRODUCED, COPIED NOR ITS CONTENTS DIVULGED WITHOUT THEIR PERMISSION.  
© DAVID SMITH ASSOCIATES

**PRELIMINARY**

**CLIENT**  
MONOWORLD RECYCLING LTD.

**CONTRACT**  
PROPOSED BUILDING & CAR PARK  
19-26 SANDERS LODGE  
INDUSTRIAL ESTATE, RUSHDEN

**TITLE**  
LOCATION PLAN

**ARCHITECT**

DRAWN	CHECKED	DATE	SCALE
GM	RJ	04.08.20	1:1250 @ A2

**David Smith Associates**  
Consulting Structural & Civil Engineers

Tel: (01604)782620  
Email: northampton@dsagroup.co.uk  
Website: www.dsagroup.co.uk

8 Duncan Close  
Moulton Park  
Northampton NN3 6WL

DRAWING NUMBER	20	39314/64	REVISION	P1
----------------	----	----------	----------	----