

Disclaimer:
 This drawing is subject to copyright, C, and in the property of A.T. Architects Limited and must not be copied or altered in any way without the written permission. This drawing should be used in conjunction with all applicable regulatory design drawings, together with any other A.T. Architects Limited drawings and the appropriate specifications as issued. No liability will be accepted for any amendments made to this drawing by third-party parties.
 This drawing must not be used. The contractor is to report all general discrepancies, errors or omissions to A.T. Architects Limited prior to commencing construction works. The contractor shall also check and verify all building work, all foundations, services, systems, plants etc. prior to commencing any works, and notify A.T. Architects Limited of any discrepancies or inaccuracies accordingly.

Checked by
AMP

Revised by

Revised by	Change Name	Issue Date
CLK	Initial Issue	28/03/2017

Revised by	Issue Name	Issue Date	Issued By
CLK	Drawing Update	28/03/2017	Robert Drayton

This drawing is for Building Regulation purposes only. This is not a Construction Issue drawing.

AW/04/04

Project:
**Extension to Industrial Unit
 Drayton Fields Industrial
 Estate
 Sogwith Way
 Daventry
 NN11 5EA**
 Client:
Nene Group Plc

Drawing Title:
**Proposed Building
 Control**
 Ground Floor Plan Sheet
2
 Date:
28/03/2017

Purpose of Issue:
Building Control
 Drawn by:
RDS
 Scale:
1:100
 Drawing No. / Rev:
1194-0605-01
 Date:
AO

Building Control

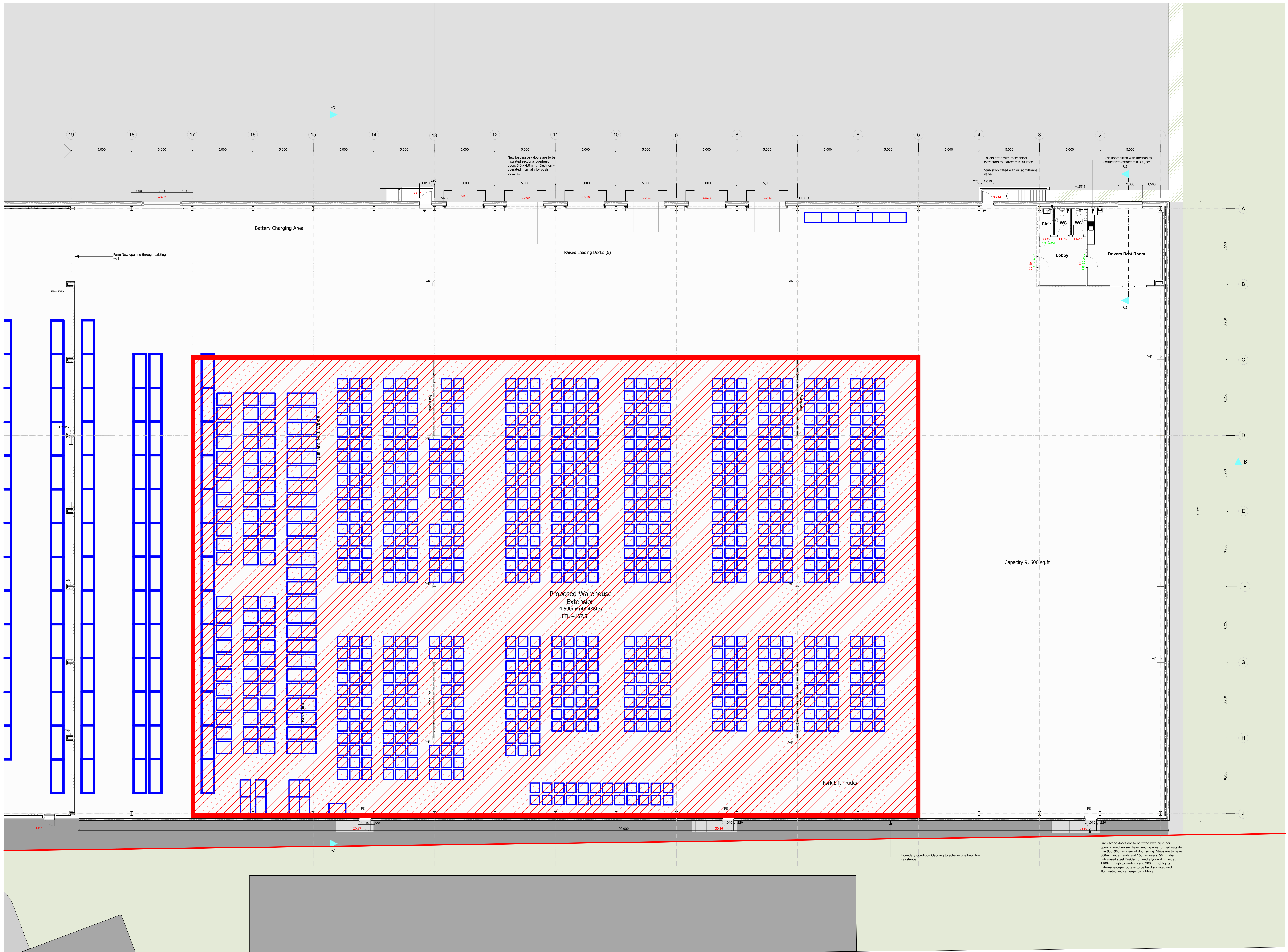
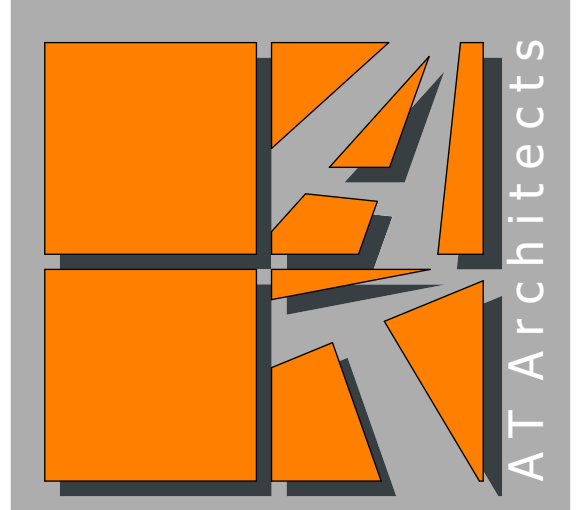

Ground Floor Plan Sheet 2
 1:100